

## Ceramic Dualband Filter

### Features/Benefits

- Ceramic Filter
- Surface Mount
- Made in U.S.A.
- Hermetic

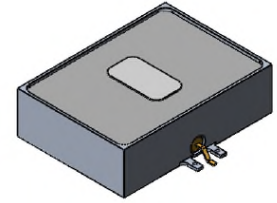

Parameter	Specification
<b>Channel 1 (L1)</b>	
Center Frequency (Fo)	1575.42 MHz
Passband	-0.3 dBc max from 1563.42 MHz to 1587.42 MHz
Return Loss	14 dB min from 1563.42 MHz to 1587.42 MHz
Insertion Loss	1.6 dBa max from 1563.42 MHz to 1587.42 MHz
Rejection	-52 dBc min @ 960 MHz -28 dBc min @ 1315 MHz -40 dBc min @ 1440.42 MHz -32 dBc min @ 1475.42 MHz -24 dBc min @ 1505.42 MHz -19 dBc min @ 1515.42 MHz -15 dBc min @ 1542.42 MHz -15 dBc min @ 1625.42 MHz -19 dBc min @ 1635.42 MHz -24 dBc min @ 1645.42 MHz -32 dBc min @ 1675.42 MHz -40 dBc min @ 1710.42 MHz -52 dBc min @ 2000 MHz -40 dBc min @ 2000 MHz to 2500 MHz
Group Delay (ns)	4 ns max var from 1563.42 MHz to 1587.42 MHz
<b>Channel 2 (L2)</b>	
Center Frequency (Fo)	1227.6 MHz
Passband	-0.3 dBc max from 1215.6 MHz to 1239.6 MHz
Return Loss	14 dB min from 1215.6 MHz to 1239.6 MHz
Insertion Loss	1.6 dBa max from 1215.6 MHz to 1239.6 MHz
Rejection	-52 dBc min @ 960 MHz -40 dBc min @ 1092.6 MHz -32 dBc min @ 1127.6 MHz -24 dBc min @ 1157.6 MHz -19 dBc min @ 1167.6 MHz -15 dBc min @ 1177.6 MHz -15 dBc min @ 1277.6 MHz -19 dBc min @ 1287.6 MHz -24 dBc min @ 1297.6 MHz -28 dBc min @ 1315 MHz -32 dBc min @ 1327 MHz -40 dBc min @ 1362.6 MHz -52 dBc min @ 2000 MHz -40 dBc min @ 2000 MHz to 2500 MHz
Group Delay (ns)	4 ns max var from 1215.6 MHz to 1239.6 MHz
Package Outline	IMC Document Number 623479
Temperature, Operating	-20°C to +70°C
Temperature, Storage	-55°C to +125°C
Temperature, Soldering	+215°C MAX (use convective reflow)
Mechanical Dimensions	0.900 x 1.25 x 0.35 inches [22.86 x 31.75 x 8.89 mm] (L X W X H)

This document contains IMC proprietary information and is to be used only for the purposes for which it has been supplied and is not to be duplicated or disclosed in whole or in part without written permission from a duly authorized representative of IMC.

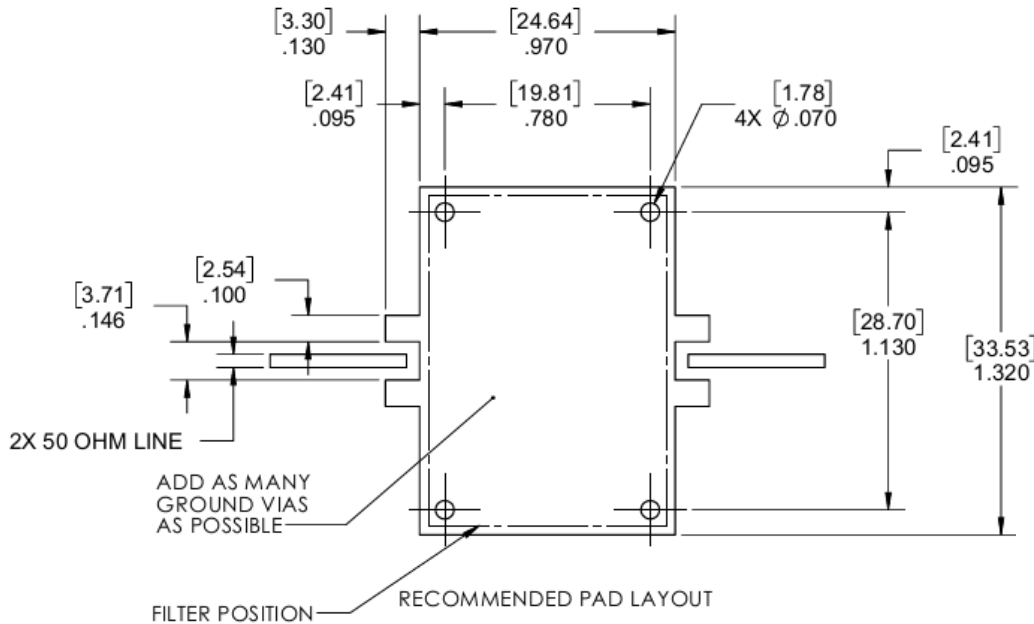
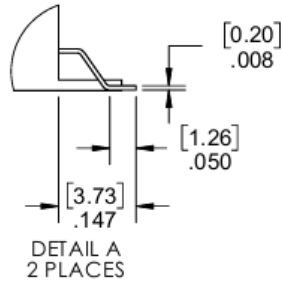
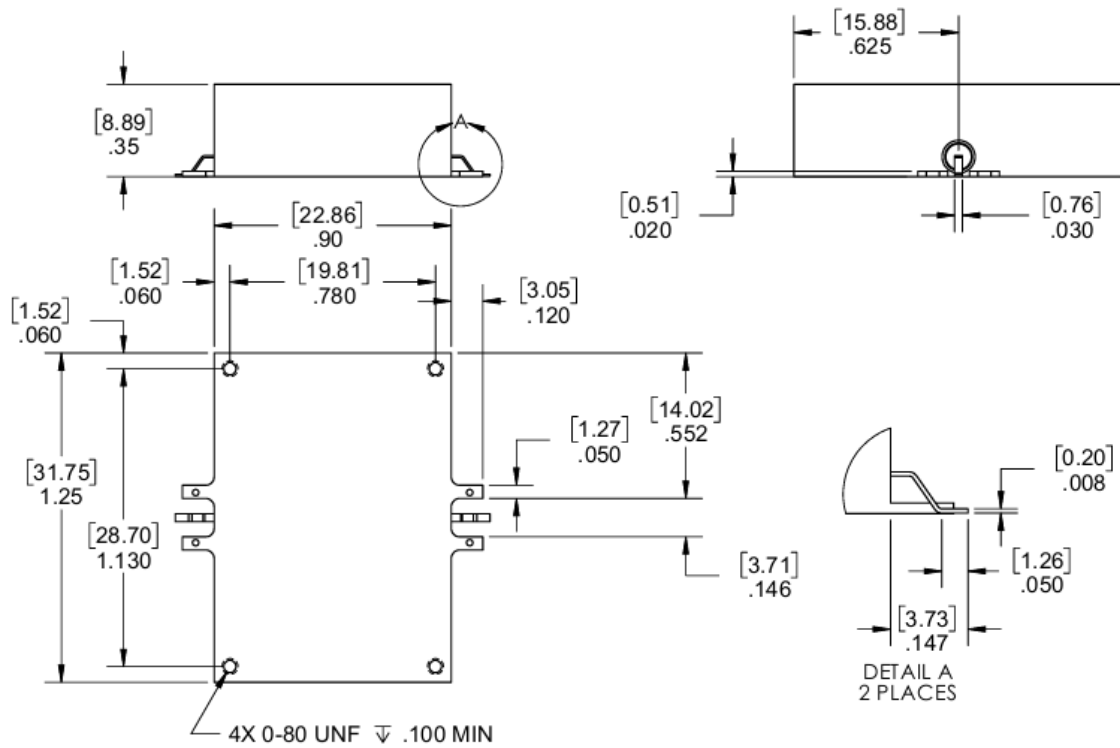
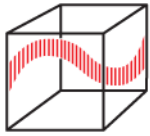

UNLESS OTHERWISE SPECIFIED  
DIMENSIONS ARE IN INCHES.  
TOLERANCES ARE:

INCHES	MILLIMETERS
.XX ± .02	[X.X] ± .5
.XXX ± .020	[X.XX] ± .51
.XXXX ± .0020	[X.XXXX] ± .051

This document contains IMC proprietary information and is to be used only for the purposes for which it has been supplied and is not to be duplicated or disclosed in whole or in part without written permission from a duly authorized representative of IMC.

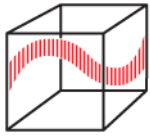

## INTEGRATED MICROWAVE CO

IMC FSCM 60656

25 °C

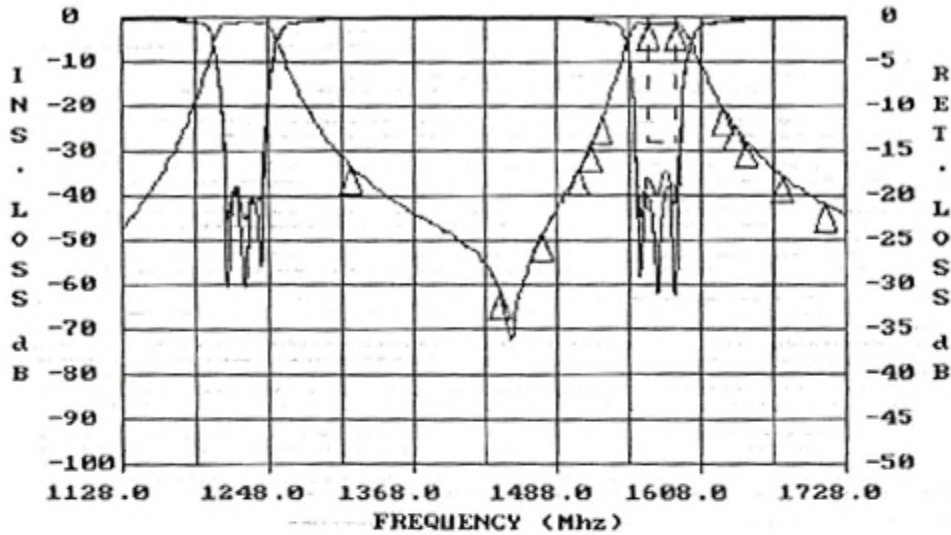

IMC P/N 943627CH1

REVISION

TESTED BY 9668

05-20-2004

07:19:55

S/N

FREQUENCY (MHZ)	VALUE	SPEC	COMMENTS
1315	-31.9 dbC	-28 dbC MIN	
1440.42	-60.6 dbC	-40 dbC MIN	
1475.42	-47.6 dbC	-32 dbC MIN	
1505.42	-33.1 dbC	-24 dbC MIN	
1515.42	-27.6 dbC	-19 dbC MIN	
1525.42	-21.3 dbC	-15 dbC MIN	
1625.42	-18.9 dbC	-15 dbC MIN	
1635.42	-23.0 dbC	-19 dbC MIN	
1645.42	-26.5 dbC	-24 dbC MIN	
1675.42	-34.4 dbC	-32 dbC MIN	
1710.42	-40.5 dbC	-40 dbC MIN	
1563.4- 1587.42	-1.52 dbA	-1.6 dbA MAX	
1563.4- 1587.42	-.268 dbC	-.3 dbC MAX	

  

FREQUENCY (MHZ)	VALUE	SPEC	COMMENTS
1563.4- 1587.42	3.62 nsC	4 nsC VAR	Group Delay

FREQUENCY (MHZ)	VALUE	SPEC	COMMENTS
1563.4- 1587.42	-17.4	-14 db MIN	(S11) - VSWR
1563.4- 1587.42	-19.0	-14 db MIN	(S22) - VSWR

This document contains IMC proprietary information and is to be used only for the purposes for which it has been supplied and is not to be duplicated or disclosed in whole or in part without written permission from a duly authorized representative of IMC.

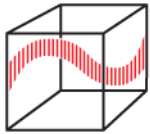

## INTEGRATED MICROWAVE CO

IMC FSCM 60656

25 °C

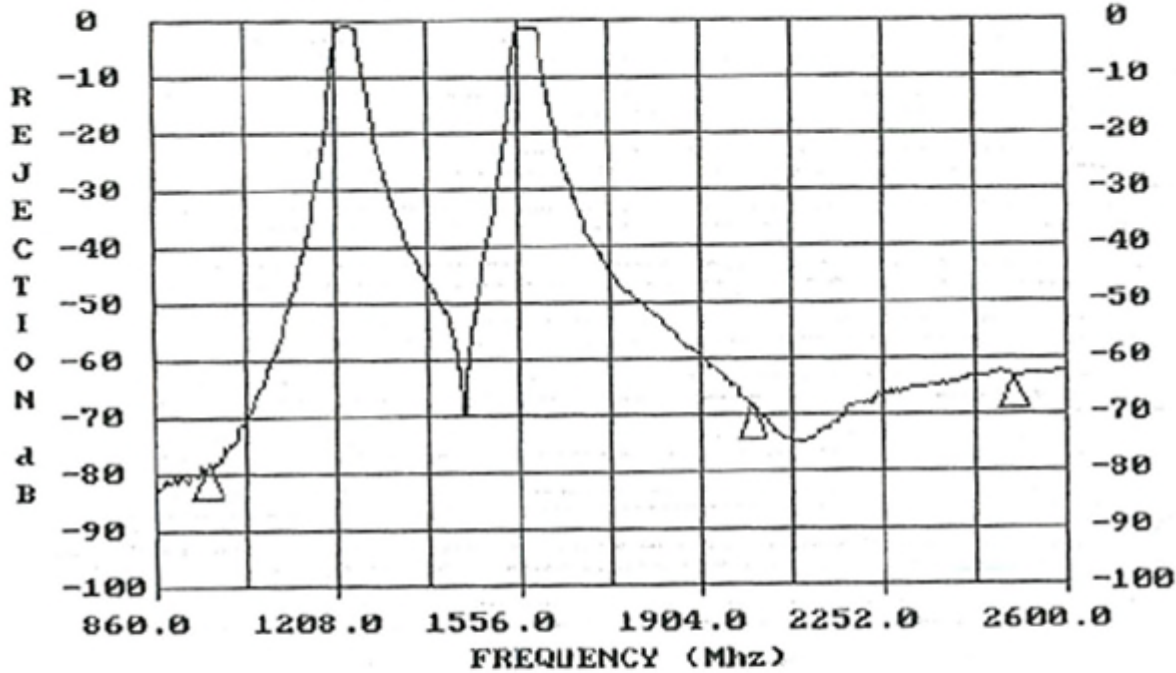

IMC P/N 943627CH1

REVISION

TESTED BY 9668

05-20-2004

07:19:56

S/N

FREQUENCY (MHZ)	VALUE	SPEC	COMMENTS
960	-76.9 dBc	-52 dBc MIN	
2000	-66.8 dBc	-52 dBc MIN	
2000 - 2500	-61.3 dBc	-40 dBc MIN	

This document contains IMC proprietary information and is to be used only for the purposes for which it has been supplied and is not to be duplicated or disclosed in whole or in part without written permission from a duly authorized representative of IMC.

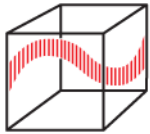

## INTEGRATED MICROWAVE CO

IMC FSCM 60656

25 °C

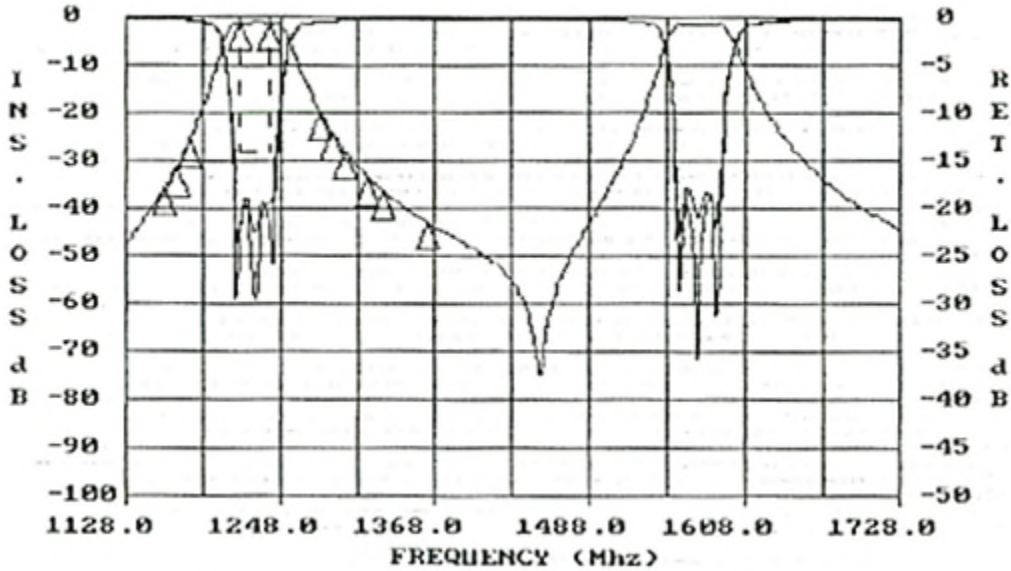

IMC P/N 943627CH2

REVISION

TESTED BY 9668

05-20-2004

07:19:33

S/N

FREQUENCY (MHZ)	VALUE	SPEC	COMMENTS
1157.6	-34.9 dbC	-24 dbC MIN	
1167.6	-30.1 dbC	-19 dbC MIN	
1177.6	-24.5 dbC	-15 dbC MIN	
1277.6	-18.5 dbC	-15 dbC MIN	
1287.6	-23.1 dbC	-19 dbC MIN	
1297.6	-26.9 dbC	-24 dbC MIN	
1315	-32.2 dbC	-28 dbC MIN	
1327.6	-35.3 dbC	-32 dbC MIN	
1362.6	-41.9 dbC	-40 dbC MIN	
1215.6- 1239.6	-1.2 dbA	-1.6 dbA MAX	
1215.6- 1239.6	-.175 dbC	-.3 dbC MAX	

FREQUENCY (MHZ)	VALUE	SPEC	COMMENTS
1215.6- 1239.6	3.41 nsC	4 nsC VAR	Group Delay

FREQUENCY (MHZ)	VALUE	SPEC	COMMENTS
1215.6- 1239.6	-18.9	-14 db MIN	(S11) - VSWR
1215.6- 1239.6	-19.5	-14 db MIN	(S22) - VSWR

This document contains IMC proprietary information and is to be used only for the purposes for which it has been supplied and is not to be duplicated or disclosed in whole or in part without written permission from a duly authorized representative of IMC.

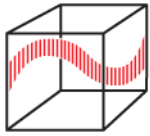

## INTEGRATED MICROWAVE CO

IMC FSCM 60656

25 °C

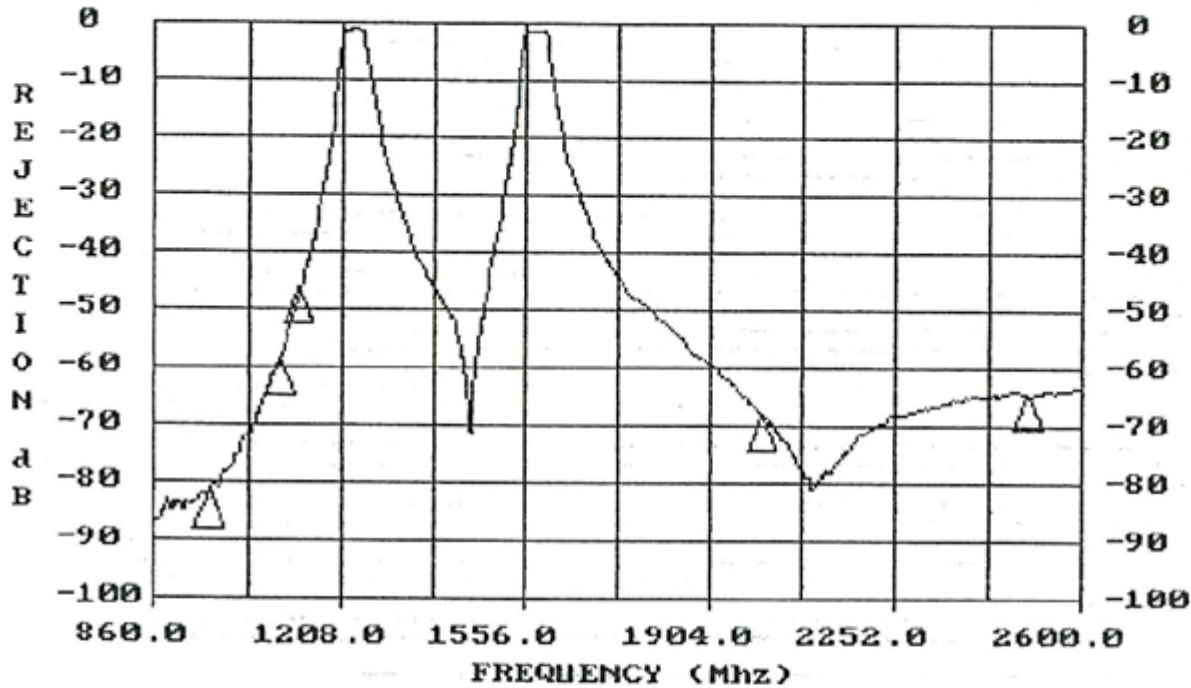

IMC P/N 943627CH2

REVISION

TESTED BY 9668

05-20-2004

07:19:34

S/N

FREQUENCY (MHZ)	VALUE	SPEC	COMMENTS
960	-80.8 dbC	-52 dbC MIN	
1092.6	-57.0 dbC	-40 dbC MIN	
1127.6	-46.0 dbC	-32 dbC MIN	
2000	-67.1 dbC	-52 dbC MIN	
2000 - 2500	-62.7 dbC	-40 dbC MIN	

This document contains IMC proprietary information and is to be used only for the purposes for which it has been supplied and is not to be duplicated or disclosed in whole or in part without written permission from a duly authorized representative of IMC.